



TRACY CLARKE
TREE CONSULTANCY

Tree Risk Survey

Client: Great Braxted Parish Council

Site: Great Braxted Recreation Ground

TCTC-19763

April 2026

Contents

Terms of Reference.....	1
The Site.....	1
Summary of Results.....	1
Tree Survey Plans.....	2
Tree Schedule.....	6
Images.....	21
Method of Assessment.....	27
Scope and Limitations.....	27
Best Practice.....	28
Legal Status.....	28
Further Information.....	29
Definition of Terms.....	31
Qualifications.....	32



Terms of Reference

Tracy Clarke Tree Consultancy Ltd are instructed by Great Braxted Parish Council to provide a Tree Risk Survey with recommendations for works by carrying out a formal assessment of all trees at Great Braxted Recreation Ground.

All trees are assessed, and all trees are recorded and mapped. Key trees and trees that require work to mitigate risk are recorded as individuals. Woodland areas and groups of trees are recorded as groups.

Trees that require work are also tagged to assist in their future identification to carry out the works.

See Tree Survey Plan which shows all the trees included in this survey.

The site was visited on 7 April 2026

The Site

The site address:

Great Braxted Recreation Ground
Tiptree Road
Great Braxted
Witham
CM8 3EF

The Local Authority: Maldon District Council

Summary of Results

Sixty-two individual trees, three groups and one woodland have been assessed.

Overall the population is in good condition.

Six trees require work to mitigate risk:

Three trees require deadwood removed / stabilised (T44, T50 and T65)

Two trees have partially failed and need to be felled to ground level (T32 and T33).

The other tree (T30), is an ancient tree within the woodland group W31. This is a significant and important tree. Ideally ancient trees should have as little work carried out on them as possible, and where there is a risk it is preferable to manage the target rather than the tree if possible. T30 is already within a wooded area with lower usage than the park. Erecting a fence around the tree at least as wide as the crown extent would further lower the risk to a point where remedial work to the tree would not be required.

For the location of all trees assessed see the Tree Survey Plans.

For detailed results of each tree assessed and any recommended works to mitigate risk see the Tree Schedule.

It is recommended that the frequency of assessment is every 2 years.

Tree Survey Plans

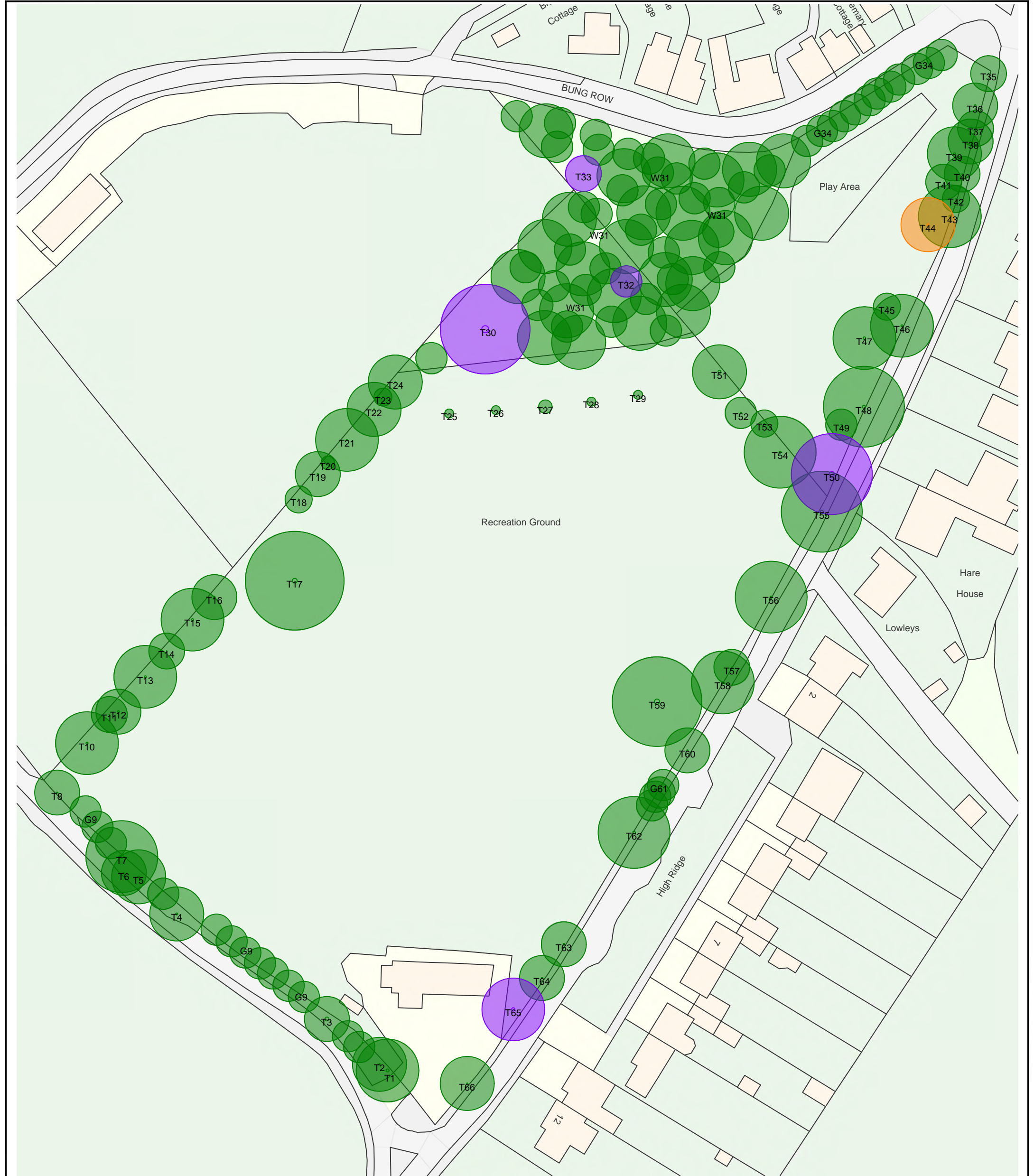

TRACY CLARKE
TREE CONSULTANCY

01371 811831 | info@tracyclarke.co.uk | www.tracyclarke.co.uk

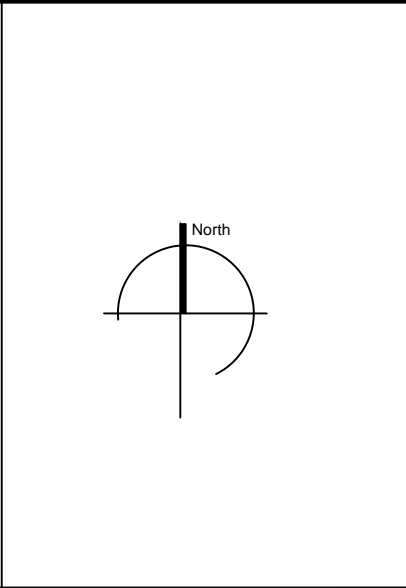

Key

- Works within 7 Days
- Works within 1 month
- Works within 3 months
- Works within 6 months
- Works within 1 year
- No work required
- Tree groups and hedges. Illustrative of area only. Not representative of actual tree numbers, location or crowns

Date	Revision	Description
---	---	---

Title
Tree Risk Survey - Overview

Client
Great Braxted Parish Council

Site
Great Braxted Recreation Ground

Dwg Ref: TCTC-19763-RA-00	Rev: -	Scale: 1:1000 @ A3
Status: Risk	Date: April 2026	Drawn By: AC

Do not scale from this drawing, tree positions and dimensions should always be checked on site.

The original of this drawing is in colour, do not rely on monochrome versions.

This drawing is copyright Tracy Clarke Tree Consultancy Ltd. ©

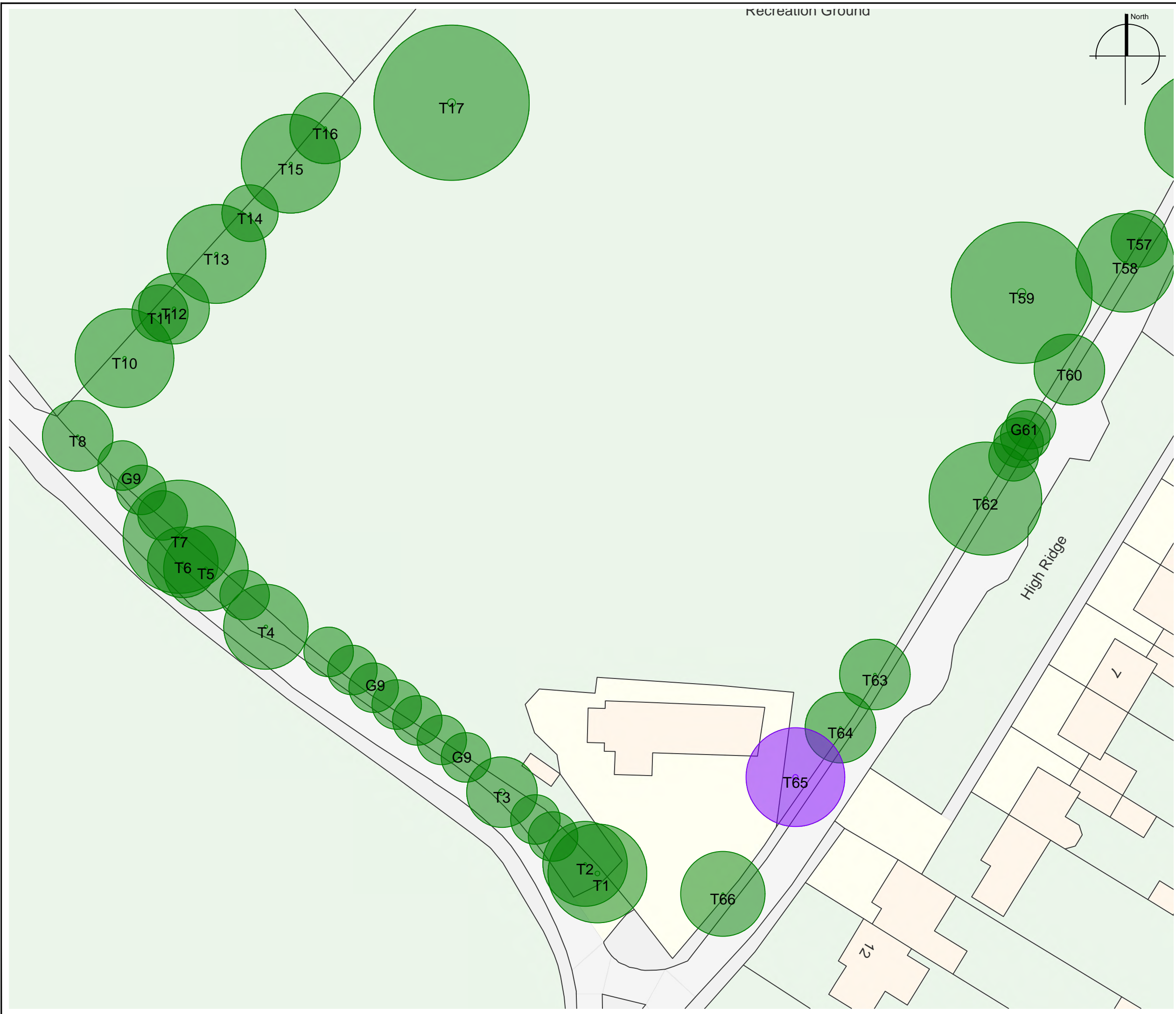

Key

- Works within 7 Days
- Works within 1 month
- Works within 3 months
- Works within 6 months
- Works within 1 year
- No work required
- Tree groups and hedges. Illustrative of area only. Not representative of actual tree numbers, location or crowns



Do not scale from this drawing, tree positions and dimensions should always be checked on site. The original of this drawing is in colour, do not rely on monochrome versions. This drawing is copyright Tracy Clarke Tree Consultancy Ltd.



Date	Revision	Description
---	---	---

Title
Tree Risk Survey - Plan 1

Client
Great Braxted Parish Council

Site
Great Braxted Recreation Ground

Ref: TCTC-19763-RA-01 **Rev:** - **Scale:** 1:500 @ A3

Status: Risk **Date:** April 2026 **Drawn By:** AC

TRACY CLARKE
TREE CONSULTANCY

[t 01371 811831](tel:01371811831) info@tracyclarke.co.uk www.tracyclarke.co.uk



Key

- Works within 7 Days
- Works within 1 month
- Works within 3 months
- Works within 6 months
- Works within 1 year
- No work required
- Tree groups and hedges. Illustrative of area only. Not representative of actual tree numbers, location or crowns

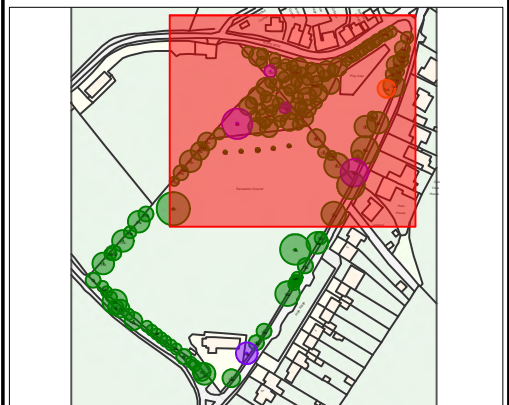

Do not scale from this drawing, tree positions and dimensions should always be checked on site. The original of this drawing is in colour, do not rely on monochrome versions. This drawing is copyright Tracy Clarke Tree Consultancy Ltd.



Date	Revision	Description
---	---	---

Title
Tree Risk Survey - Plan 2

Client
Great Braxted Parish Council

Site
Great Braxted Recreation Ground

Ref:TCTC-19763-RA-02 **Rev:** - **Scale:**1:500 @ A3

Status: Risk **Date:** April 2026 **Drawn By:** AC

TRACY CLARKE
TREE CONSULTANCY

[t 01371 811831](tel:01371811831) info@tracyclarke.co.uk www.tracyclarke.co.uk

Tree Schedule

Tree Risk Schedule and Recommendations



Site: Great Braxted Recreation Ground

Date: April 2026

Tree / Group No.	Tag Number	W3W	Species	Number of Stems	Height (m)	DBH (cm)	Crown Spread (m)	Vitality	Age Class	Physiological Condition	Structural Condition	Targets	Notes and Observations	Recommended works	Priority
T1	Not tagged	compacts.landowner.gems	Quercus robur (English Oak)	1	14	66	14	High	Mature	Good	Good	Road within crown spread Car parking below tree canopy	Minor deadwood throughout crown - low risk.	No work required	-
T2	Not tagged	compacts.landowner.gems	Fraxinus excelsior (Ash)	1	15	35	12	Moderate	Early Mature	Fair	Fair	Road within crown spread Car parking below tree canopy	Minor deadwood throughout crown - low risk. Early stage ash dieback suspected.	No work required	-
T3	Not tagged	leap.vibes.reprints	Quercus robur (English Oak)	1	8	90	10	Moderate	Mature	Fair	Fair	Road within crown spread Recreational area within falling distance	Crown has been topped / significantly reduced. Existing crown consists entirely of resulting epicormic growth.	No work required	-
T4	Not tagged	vital.pizzeria.packages	Quercus robur (English Oak)	1	12	50	12	High	Mature	Good	Good	Road within crown spread Recreational area within crown spread	Crown has been pruned back from overhead wires. Damage to base if stem on the roadside - decay currently localised.	No work required	-
T5	Not tagged	await.aboard.sanded	Quercus robur (English Oak)	1	12	40	12	High	Mature	Good	Good	Road within crown spread Recreational area within crown spread	No significant defects observed.	No work required	-

Tree / Group No.	Tag Number	W3W	Species	Number of Stems	Height (m)	DBH (cm)	Crown Spread (m)	Vitality	Age Class	Physiological Condition	Structural Condition	Targets	Notes and Observations	Recommended works	Priority
T6	Not tagged	morphing.mascot.sharpens	Quercus robur (English Oak)	1	10	30	10	Moderate	Early Mature	Fair	Fair	Road within crown spread Recreational area within crown spread	Bud density a little thin - tree may be in decline.	No work required	—
T7	Not tagged	performed.pounce.tent	Pinus nigra (Black Pine)	1	16	75	16	High	Mature	Good	Good	Road within crown spread Recreational area within crown spread	Minor deadwood throughout crown - low risk.	No work required	—
T8	Not tagged	sheds.impeached.cracking	Prunus sp. (Cherry)	1	7	30	10	High	Mature	Good	Good	Road within crown spread Recreational area within crown spread	No significant defects observed.	No work required	—
G9	Not tagged	handbag.precautions.fetching	Acer campestre (Field Maple) Crataegus monogyna (Common Hawthorn) Ilex aquifolium (Holly) Prunus spinosa (Blackthorn) Ulmus procera (English Elm)		10	20		Moderate	Semi Mature	Fair	Fair	Road within crown spread Recreational area within crown spread	Semi-mature group of predominately elm with occasional holly, field maple, hawthorn and blackthorn. Elm is susceptible to Dutch elm disease and these trees are likely to succumb over time, but they are currently in fair condition overall. Average stem diameter given. Numbers in group not counted.	No work required	—

Tree / Group No.	Tag Number	W3W	Species	Number of Stems	Height (m)	DBH (cm)	Crown Spread (m)	Vitality	Age Class	Physiological Condition	Structural Condition	Targets	Notes and Observations	Recommended works	Priority
T10	Not tagged	client.meanders.snippet	Quercus robur (English Oak)	1	11	45	14	High	Mature	Good	Good	Recreational area within crown spread	No significant defects observed.	No work required	—
T11	Not tagged	written.closer.relatives	Quercus robur (English Oak)	1	10	20	8	High	Semi Mature	Good	Good	Recreational area within crown spread	Crown suppressed by adjacent tree.	No work required	—
T12	Not tagged	blanks.graves.frightens	Pinus sylvestris (Scots Pine)	1	10	45	10	High	Early Mature	Good	Fair	Recreational area within crown spread	Minor deadwood in lower crown - low risk.	No work required	—
T13	Not tagged	term.object.culling	Quercus robur (English Oak)	1	10	50	14	High	Mature	Good	Good	Recreational area within crown spread	No significant defects observed.	No work required	—
T14	Not tagged	messy.older.swells	Carpinus betulus (Hornbeam)	1	5	20	8	High	Semi Mature	Good	Good	Recreational area within crown spread	No significant defects observed.	No work required	—
T15	Not tagged	safest.stunts.promising	Quercus robur (English Oak)	1	7	43	14	High	Early Mature	Good	Good	Recreational area within crown spread	No significant defects observed.	No work required	—

Tree / Group No.	Tag Number	W3W	Species	Number of Stems	Height (m)	DBH (cm)	Crown Spread (m)	Vitality	Age Class	Physiological Condition	Structural Condition	Targets	Notes and Observations	Recommended works	Priority
T16	Not tagged	supper.alleyway.immunity	Pinus sylvestris (Scots Pine)	1	7	40	10	High	Early Mature	Good	Good	Recreational area within crown spread	No significant defects observed.	No work required	—
T17	Not tagged	scatter.tramps.unhappily	Quercus robur (English Oak)	1	20	111	22	High	Mature	Good	Good	Recreational area within crown spread	Large pruning wounds on main stem at 3 metres. Decayed stub at 7 metres on north east side with woodpecker holes - epicormic growth on stub currently minor and low risk. Stem base and buttress roots appear sound.	No work required	—
T18	Not tagged	romance.tracking.slouched	Quercus robur (English Oak)	2	4	15	6	High	Semi Mature	Good	Good	Recreational area within crown spread	No significant defects observed.	No work required	—
T19	Not tagged	handlebar.headlines.critic	Carpinus betulus (Hornbeam)	1	6	28	10	High	Semi Mature	Good	Good	Recreational area within crown spread	No significant defects observed.	No work required	—
T20	Not tagged	grumbling.works.founding	Quercus robur (English Oak)	1	7	14	3	High	Semi Mature	Good	Good	Recreational area within crown spread	No significant defects observed.	No work required	—

Tree / Group No.	Tag Number	W3W	Species	Number of Stems	Height (m)	DBH (cm)	Crown Spread (m)	Vitality	Age Class	Physiological Condition	Structural Condition	Targets	Notes and Observations	Recommended works	Priority
T21	Not tagged	hindering.period.resold	Quercus robur (English Oak)	2	8	23	14	High	Early Mature	Good	Good	Recreational area within crown spread	Twin stemmed - basal fork appears stable.	No work required	—
T22	Not tagged	sundial.masts.mimic	Juglans regia (Walnut)	1	8	28	12	High	Semi Mature	Good	Good	Recreational area within crown spread	No significant defects observed.	No work required	—
T23	Not tagged	cakewalk.husbands.scribbled	Quercus robur (English Oak)	1	5	14	4	High	Semi Mature	Good	Good	Recreational area within crown spread	No significant defects observed.	No work required	—
T24	Not tagged	wrenching.develops.diverting	Quercus robur (English Oak)	3	7	20	12	High	Early Mature	Good	Fair	Recreational area within crown spread	Multi-stemmed - basal forks appear stable.	No work required	—
T25	Not tagged	charts.advising.trinkets	Carpinus betulus (Hornbeam)	1	3	4	2	High	Young	Good	Good	Recreational area within crown spread	Young planted tree - low risk.	No work required	—

Tree / Group No.	Tag Number	W3W	Species	Number of Stems	Height (m)	DBH (cm)	Crown Spread (m)	Vitality	Age Class	Physiological Condition	Structural Condition	Targets	Notes and Observations	Recommended works	Priority
T26	Not tagged	basically.caring.evaporate	Acer sp. (Maple)	1	5	4	2	High	Young	Good	Good	Recreational area within crown spread	Young planted tree - low risk.	No work required	—
T27	Not tagged	fixtures.verifying.detect	Fagus sylvatica (Common Beech)	1	2.5	4	3	High	Young	Good	Good	Recreational area within crown spread	Young planted tree - low risk.	No work required	—
T28	Not tagged	layered.muscular.broth	Acer sp. (Maple)	1	5	4	2	High	Young	Good	Good	Recreational area within crown spread	Young planted tree - low risk.	No work required	—
T29	Not tagged	wider.credit.charities	Carpinus betulus (Hornbeam)	1	3	4	2	High	Young	Good	Good	Recreational area within crown spread	Young planted tree - low risk.	No work required	—

Tree / Group No.	Tag Number	W3W	Species	Number of Stems	Height (m)	DBH (cm)	Crown Spread (m)	Vitality	Age Class	Physiological Condition	Structural Condition	Targets	Notes and Observations	Recommended works	Priority
T30	795	loud.motive.prevents	Quercus robur (English Oak)	1	18	157	20	High	Ancient / Veteran	Good	Poor	Recreational area within crown spread	<p>A significant important tree with high wildlife and cultural value. Crown has been reduced. Entire crown scaffold structure is decayed in some form to varying extents. In the upper crown there is dieback with major and minor deadwood. The mid crown has indications of decay with the presence of woodpecker holes. Many limbs in the lower crown have decayed longitudinal strip wounds. The main stem forks into 3 at 3 metres - the stem to the north west has been reduced to 5 metres and is very decayed. The main stem sounds decayed on the north east side - there is a fruiting body of the decay fungi Ganoderma australe present. The stem also sounds potentially decayed on the north west to west side. Large buttress root to south appears sound.</p> <p>Ideally ancient trees should have as little work carried out on them as possible, and where there is a risk it is preferable to manage the target rather than the tree if possible. T30 is already within a wooded area with lower usage than the park. Erecting a fence around the tree at least as wide as the crown extent would further lower the risk to a point where remedial work to the tree would not be required.</p>	Restrict access beneath tree canopy by erecting a fence.	6 months

Tree / Group No.	Tag Number	W3W	Species	Number of Stems	Height (m)	DBH (cm)	Crown Spread (m)	Vitality	Age Class	Physiological Condition	Structural Condition	Targets	Notes and Observations	Recommended works	Priority
W31	Not tagged	doormat.gambles.walking	Mixed species including: Acer campestre (Field Maple) Carpinus betulus (Hornbeam) Corylus avellana (Common Hazel) Ilex aquifolium (Holly) Pinus sp. (Pine) Prunus sp. (Cherry) Prunus spinosa (Blackthorn) Quercus robur (English Oak) Ulmus procera (English Elm)		15	30		Moderate	Early Mature	Fair	Fair	Recreational area within crown spread Road within crown spread	Mixed woodland predominately semi-mature and early mature. Variable condition but generally fair to good. Average stem diameter given. Numbers in group not counted.	No work required	
T32	796	printers.pesky.moth	Pinus sylvestris (Scots Pine)	1	12	21	7	Dead	Semi Mature	Dead	Poor	Recreational area within crown spread	Dead tree partially failed at stem base - tree is supported by adjacent tree.	Fell to ground level	6 months
T33	797	serenade.puzzles.roost	Pinus sylvestris (Scots Pine)	1	12	25	8	Dead	Semi Mature	Dead	Poor	Recreational area within crown spread	Dead tree partially failed at stem 1.5 metres - tree is supported by adjacent tree.	Fell to ground level	6 months

Tree / Group No.	Tag Number	W3W	Species	Number of Stems	Height (m)	DBH (cm)	Crown Spread (m)	Vitality	Age Class	Physiological Condition	Structural Condition	Targets	Notes and Observations	Recommended works	Priority
G34	Not tagged	careless.screches.milky	Crataegus monogyna (Common Hawthorn), Ilex aquifolium (Holly) Prunus spinosa (Blackthorn) Ulmus procera (English Elm)		8			Moderate	Mature	Fair	Fair	Recreational area within falling distance Road within falling distance of tree	Managed as a tall hedge. Mature holly with young / semi-mature elm, blackthorn and hawthorn.	No work required	—
T35	Not tagged	soils.trombone.computer	Ilex aquifolium (Holly)	8	8	15	8	Moderate	Mature	Fair	Fair	Recreational area within crown spread Road within falling distance of tree	Multi-stemmed. Unable to access base.	No work required	—
T36	Not tagged	vans.campsites.outlawing	Acer platanoides (Norway Maple)	1	10	32	10	High	Early Mature	Good	Good	Recreational area within crown spread Road within falling distance of tree	Decayed pruning wounds.	No work required	—
T37	Not tagged	ferried.onions.planet	Ilex aquifolium (Holly)	4	8	15	8	Moderate	Mature	Fair	Fair	Recreational area within crown spread Road within falling distance of tree	Multi-stemmed. Unable to access base.	No work required	—
T38	Not tagged	froth.firewall.flame	Quercus robur (English Oak)	1	12	32	10	High	Early Mature	Good	Good	Recreational area within crown spread Road within crown spread	No significant defects observed.	No work required	—

Tree / Group No.	Tag Number	W3W	Species	Number of Stems	Height (m)	DBH (cm)	Crown Spread (m)	Vitality	Age Class	Physiological Condition	Structural Condition	Targets	Notes and Observations	Recommended works	Priority
T39	Not tagged	workflow.ties.rebirth	Fagus sylvatica (Common Beech)	1	14	42	12	High	Mature	Good	Good	Recreational area within crown spread Road within falling distance of tree	Large bark wound on south side of stem from ground level to 3 metres - large area of missing / necrotic bark. Not currently impacting on structural or physiological condition but tree will not reach potential.	No work required	-
T40	Not tagged	thirsty.insisting.stay	Ilex aquifolium (Holly)	4	5	15	8	Moderate	Mature	Fair	Fair	Recreational area within crown spread Road within falling distance of tree	Multi-stemmed. Unable to access base.	No work required	-
T41	Not tagged	curl.fattening.slips	Sorbus aucuparia (Rowan)	4	5	10	8	High	Early Mature	Good	Good	Recreational area within crown spread	Multi-stemmed - basal forks appear stable.	No work required	-
T42	Not tagged	beaten.perform.cackling	Ilex aquifolium (Holly)	2	6	15	6	Moderate	Mature	Fair	Fair	Recreational area within crown spread Road within falling distance of tree	Multi-stemmed. Unable to access base.	No work required	-
T43	Not tagged	recipient.champions.scarves	Carpinus betulus (Hornbeam)	1	15	45	14	High	Mature	Good	Good	Recreational area within crown spread Road within crown spread	No significant defects observed.	No work required	-
T44	798	dreamers.shortage.than	Aesculus hippocastanum (Horse Chestnut)	1	9	48	12	Moderate	Mature	Poor	Fair	Recreational area within crown spread Road within falling distance of tree	Advanced bacterial canker. Tree is in decline. Deadwood throughout crown. Tree is likely to continue to decline.	Remove deadwood	3 months

Tree / Group No.	Tag Number	W3W	Species	Number of Stems	Height (m)	DBH (cm)	Crown Spread (m)	Vitality	Age Class	Physiological Condition	Structural Condition	Targets	Notes and Observations	Recommended works	Priority
T45	Not tagged	alienated.rush.lunges	Sorbus aucuparia (Rowan)	1	6	18	6	High	Mature	Good	Good	Recreational area within crown spread	No significant defects observed.	No work required	—
T46	Not tagged	historic.informer.vesting	Fraxinus excelsior (Ash)	1	10	45	14	Moderate	Mature	Fair	Fair	Recreational area within crown spread Road within crown spread	Minor deadwood - low risk. Unable to access base.	No work required	—
T47	Not tagged	practical.tweezers.broom	Fagus sylvatica (Common Beech)	1	15	52	14	High	Mature	Good	Good	Recreational area within crown spread Road within falling distance of tree	No significant defects observed.	No work required	—
T48	Not tagged	unwanted.intestine.roosters	Quercus robur (English Oak)	1	14	65	18	Moderate	Mature	Fair	Fair	Recreational area within crown spread Road within crown spread	Unable to access all of base. Minor deadwood throughout crown - low risk.	No work required	—
T49	Not tagged	songbirds.insiders.lectured	Prunus cerasifera 'Pissardii' (Pissard's Plum)	1	6	18	7	Moderate	Mature	Fair	Fair	Recreational area within crown spread	No significant defects observed.	No work required	—

Tree / Group No.	Tag Number	W3W	Species	Number of Stems	Height (m)	DBH (cm)	Crown Spread (m)	Vitality	Age Class	Physiological Condition	Structural Condition	Targets	Notes and Observations	Recommended works	Priority
T50	799	sprawls.skater.bombshell	Quercus robur (English Oak)	1	17	118	18	High	Mature	Good	Fair	Recreational area within crown spread Road within crown spread	Major and minor deadwood throughout crown. Major deadwood over road. 'lifebelt' feature around lower stem. Lower stem and buttress roots appear sound.	Stabilise deadwood.	6 months
T51	Not tagged	fancy.craftsman.resist	Quercus robur (English Oak)	1	10	70	12	High	Mature	Good	Fair	Recreational area within crown spread	Stem forks at 1 metre - forks appear stable.	No work required	-
T52	Not tagged	entitles.delivers.wells	Quercus sp. (Oak)	1	7	25	7	High	Semi Mature	Good	Good	Recreational area within crown spread	Decayed pruning wounds.	No work required	-
T53	Not tagged	texts.outlooks.hires	Cerasus avium (Wild Cherry)	1	8	20	6	High	Semi Mature	Good	Good	Recreational area within crown spread	No significant defects observed.	No work required	-
T54	Not tagged	dodges.bump.promising	Quercus robur (English Oak)	1	14	47	16	High	Mature	Good	Good	Recreational area within crown spread	Pruning wounds around stem circumference at 1.5 metres - almost completely occluded.	No work required	-
T55	Not tagged	zoned.baking.annual	Quercus robur (English Oak)	1	17	70	18	High	Mature	Good	Good	Recreational area within crown spread Road within crown spread Seating area within crown spread	Minor deadwood throughout crown - low risk.	No work required	-

Tree / Group No.	Tag Number	W3W	Species	Number of Stems	Height (m)	DBH (cm)	Crown Spread (m)	Vitality	Age Class	Physiological Condition	Structural Condition	Targets	Notes and Observations	Recommended works	Priority
T56	Not tagged	tasks.unsigned.rams	Quercus robur (English Oak)	1	9	45	16	High	Mature	Good	Fair	Recreational area within crown spread Road within crown spread	Decayed pruning wounds. Minor deadwood throughout crown - low risk.	No work required	-
T57	Not tagged	dwarf.howler.surcharge	Salix caprea (Goat Willow)	3	8	20	8	Moderate	Mature	Fair	Fair	Recreational area within crown spread Road within crown spread	Minor deadwood throughout crown - low risk. Multi-stemmed - basal forks appear stable.	No work required	-
T58	Not tagged	driveways.drama.harsh	Quercus robur (English Oak)	1	10	34	14	High	Early Mature	Good	Good	Recreational area within crown spread Road within crown spread	Minor deadwood throughout crown - low risk.	No work required	-
T59	Not tagged	shave.spends.variances	Quercus robur (English Oak)	1	17	119	20	High	Mature	Good	Fair	Recreational area within crown spread Road within falling distance of tree	Crown has been reduced. Large pruning wound on main stem at 3 metres. Tearout wound on large lower limb to south. Minor deadwood throughout crown - low risk. Lower stem and buttress roots appear sound.	No work required	-
T60	Not tagged	shred.taps.streetcar	Quercus robur (English Oak)	1	10	25	10	High	Semi Mature	Good	Good	Recreational area within crown spread Road within crown spread	Outside fence. No significant defects observed.	No work required	-
G61	Not tagged	head.lights.playful	Prunus sp (Cherry)	4	10	25		High	Early Mature	Good	Fair	Recreational area within crown spread Road within crown spread	Group of 4 cherry trees. 1 tree is dead but is a low risk due to small size. Average stem diameter given.	No work required	-

Tree / Group No.	Tag Number	W3W	Species	Number of Stems	Height (m)	DBH (cm)	Crown Spread (m)	Vitality	Age Class	Physiological Condition	Structural Condition	Targets	Notes and Observations	Recommended works	Priority
T62	Not tagged	mango.ropes.remission	Quercus robur (English Oak)	1	12	54	16	High	Mature	Good	Good	Recreational area within crown spread Road within crown spread	No significant defects observed.	No work required	—
T63	Not tagged	directive.overdrive.lengthen	Quercus robur (English Oak)	1	9	34	10	High	Early Mature	Good	Good	Recreational area within crown spread Road within crown spread	Decayed pruning wound.	No work required	—
T64	Not tagged	takes.flush.windpipe	Quercus robur (English Oak)	1	9	29	10	High	Semi Mature	Good	Good	Recreational area within crown spread Road within crown spread	Small branch partially torn out over road - low risk.	No work required	—
T65	800	hillsides.icon.trace	Quercus robur (English Oak)	1	11	76	14	Moderate	Mature	Poor	Poor	Recreational area within crown spread Road within crown spread Building within falling distance of tree	Tree is in decline. Upper stem is dead. Major and minor deadwood throughout crown. Major deadwood over road. Bark wound at base of stem west side. Areas of necrotic bark around stem base on north, east and south sides up to 1 metre - indication of dysfunction.	Stabilise deadwood.	6 months
T66	Not tagged	extremes.threaded.rewrites	Fraxinus excelsior (Ash)	3	15	30	12	Moderate	Mature	Fair	Fair	Car parking below tree canopy Road within crown spread	Minor deadwood. Early stage ash dieback suspected. Multi-stemmed - basal forks appear stable.	No work required	—

Images



Image 1 - T30 Ancient tree



Image 2 - T30

Images



Image 3 - T30 Decayed scaffold structure



Image 4 - T30 Mid crown woodpecker holes

Images



Image 5 - T32 Partially failed



Image 6 - T32 Partially failed

Images



Image 7 - T33 Partially failed



Image 8 - T33 Partially failed

Images



Image 9 - T44 Deadwood



Image 10 - T50 Deadwood

Images



Image 11 - T65 Deadwood

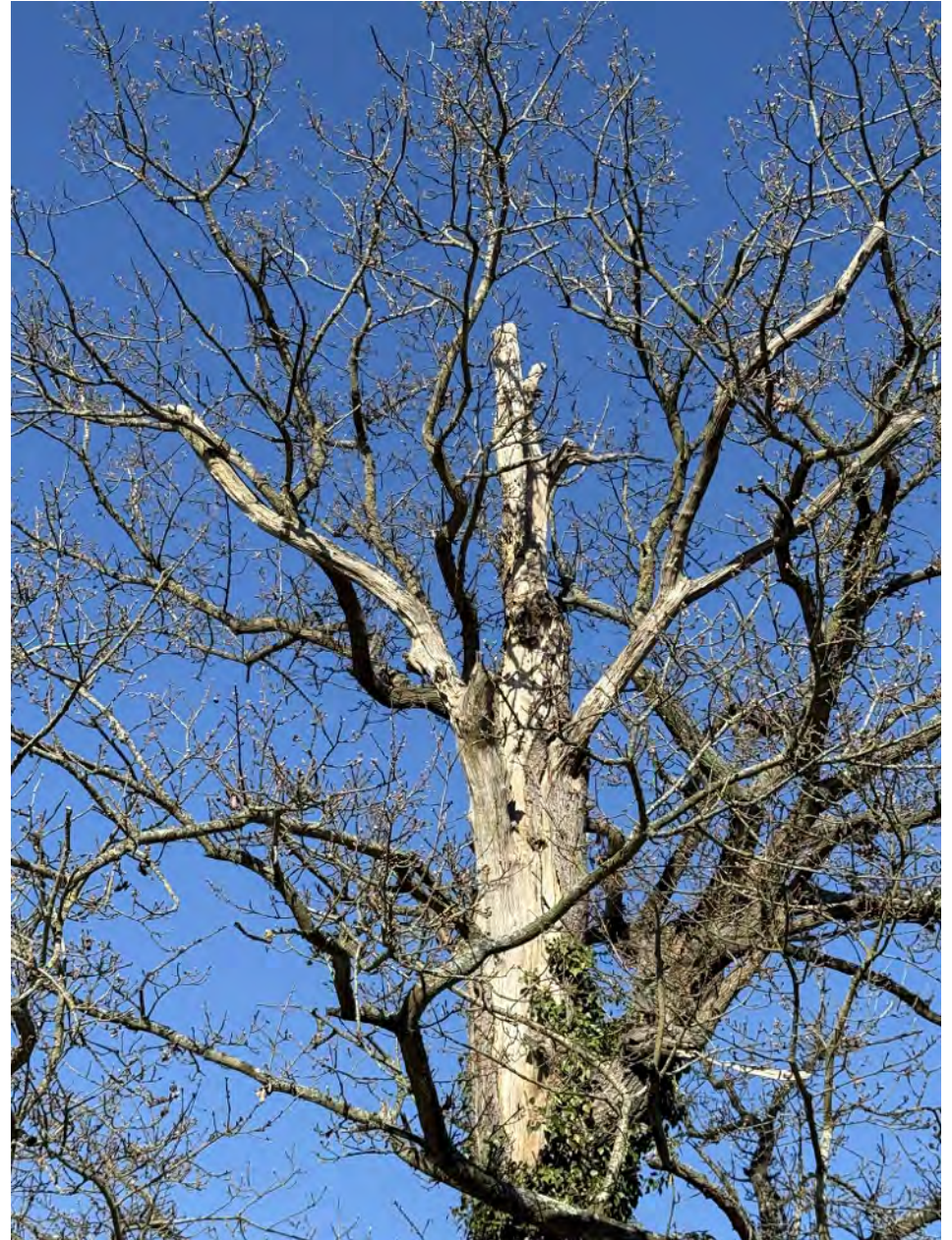

Image 12 - T65 Deadwood

Method of Assessment

A Formal Inspection is carried out for every tree in the Survey Area of the property. This follows a structured process called Visual Tree Assessment (VTA). Every tree is inspected from ground level, the health of the tree assessed, and any obvious defects identified.

All trees are plotted individually (unless grouping is reasonable and unambiguous) using tree survey mapping software. The position of trees will be estimated using GPS.

The following data is collected:

- Tree reference number
- Tree tag number (the tree will be tagged if one does not exist)
- Species
- Estimated height (m)
- Estimated stem diameter (cm) measured at 1.5m above ground level
- Estimated crown spread diameter (m)
- Life stage
- Physiological condition
- Structural condition
- Notes and observations of defects
- Recommended works
- Bat Roost Potential
- Works will usually be prioritised to within – 7 days / 3 Months / 6 Months / 1 Year / 2 Year

Scope and Limitations

All trees have been inspected from ground level only applying Mattheck's (1994) Visual Tree Assessment method (VTA)*. For individual high value trees, a more detailed assessment is sometimes required, and may be a recommendation from this visual assessment. This may be an assessment of the rooting environment, an aerial inspection of the upper stem and crown, a detailed decay investigation, or stability assessment.

Recommended timing of works and frequency of assessment may be made following the guidance produced by The National Tree Safety Group's report 'Common sense risk management of trees' (2011)**.

Tree positions are approximate only.

Observations and recommendations of trees in this report do not allow for extreme weather events. It is recommended that a High Winds Policy is developed to manage Tree Risk during storms.

All trees should be inspected following storms and extreme weather events to identify any damage or changes in condition of the trees that may have occurred.

All recommendations are given in the context of the sites current use.

Trees are dynamic living organisms, and subject to changes in their condition. They are susceptible to effects from disease, weather and changes to their surrounding environment.

The assessment of trees within this report is valid for two years from the date of inspection.

*Mattheck, C, Broeler, H. (1994). The body language of trees. A handbook for failure analysis – Research for Amenity Trees No.4 Research for Amenity Trees

**NTSG (2024): COMMON SENSE RISK MANAGEMENT OF TREES (Forestry Commission, Edinburgh)

Best Practice

Any works recommended will have been given a priority - a timescale that the works need to be carried out. However, where possible within these timescales it is beneficial to the tree if major works are undertaken during periods of lower functional activity. This may be during the winter when the tree is dormant (November to end of February), or during late July to the end of August when the tree is less active. During these periods the tree is better able to react to wounding and a decrease in leaf area.

It should be noted that during July and August there are potential implications regarding protected species - see next section: Legal Status.

All tree works should comply with BS3998: (2010) Tree Work - Recommendations.

Arborists carrying out the work should be suitably qualified and insured

Legal Status

No details have been requested from the Local Planning Authority (LPA) as to whether the tree on the site is within a Conservation Area or protected by a Tree Preservation Order (TPO) as Malden District Council only holds paper copies of their Tree Preservation Orders.

Prior to any works to prune or remove a tree protected by a TPO or within a Conservation Area written consent from the LPA is required.

Care should be taken in regard to species and their habitats that are protected under the Wildlife and Countryside Act 1981, the Countryside and Rights of Way Act 2000 (CRoW Act) and the consolidation of the Conservation of Habitats and Species Regulations 2010 (the 'Habitat Regulations 2017').

With tree work this particularly refers to birds and bats.

Ideally, if possible, work should be undertaken outside of the bird nesting season (March to September).

A scoping survey that identifies Potential Bat Features (PRF's) and the likelihood of a tree being used by bats is included as part of the Visual Tree Assessment. This survey follows BS8596: (2015) Surveying for Bats in Trees and Woodland - Guide. Trees are rated as Negligible / Low / Medium / High / Confirmed.

A Negligible or Low rating means that no further action is required, and works can be carried out on the tree.

If rated as Medium, tree surgery works should only proceed with caution, with the arborist following best practice.

If rated as High, a Secondary Survey should be carried out to confirm or discount the presence of bats.

If Confirmed, either from the Scoping Survey or Secondary Survey, a Natural England European Protected Species Licence will be required, and a Licensed Bat Worker must be contacted and involved in the process.

Further Information

Detailed Assessments:

One of the limitations of a Formal Inspection is that it is carried out from the ground with standard equipment to assist with the assessment of trees. Sometimes faults are observed that cannot be fully assessed as they are either out of reach or internal to the tree.

For trees of high value, a Detailed Inspection can determine the extent of the fault and enable a more accurate specification of works.

Without this additional information, a more precautionary approach, which often means a more severe specification, may have to be recommended.

Detailed Inspections obviously require additional resource and so are only recommended when the tree is considered of high enough value, either for amenity, wildlife conservation or for cultural reasons.

If the tree is protected by a Tree Preservation Order the Local Authority may insist on a Detailed Investigation to justify works.

Priority of Works:

All recommended works are prioritised depending on the degree of the hazard and the level of risk, usually from 7 days to 2 years.

It should be noted that different recommended works on the same tree may have different priorities as they are assessed separately.

It is often more efficient to have works carried out at the same time, and so this should be considered when reviewing the recommendations and planning the remedial work with an arborist.

Ivy / Epicormic Growth:

Ivy is very rarely a problem for a tree and can in fact add to the biodiversity and habitat value of a tree. However, when it prevents the full assessment of a tree for risk in a High Usage Zone, we will usually recommend its removal.

Ivy can obscure faults that present a significant risk.

The recommendation is usually in the form of 'Sever and Strip'. It is suggested that the ivy is severed at the bottom of the tree, leaving at least 15cm gap in the cut stems. This can then be left for a period of time to die back and should then be stripped from the tree.

Depending on the extent and height of the ivy this may need to be carried out by an arborist.

Dead or dying ivy is much easier to remove from a tree, but it should be noted that large sections of dead ivy, if left, may present a hazard in itself and should be removed as soon as it is practicable.

Some trees (such as lime trees) produce epicormic growth from the base of the stem, and sometimes up the stem as well.

This is small diameter growth that can obscure the base of the tree and prevent the identification of decay in the lower stem.

Therefore, it may be recommended for this growth to be removed to enable full assessment of the tree.

Trees that have ivy or epicormic growth to an extent that there is a recommendation to remove it, have not been fully assessed and so cannot be considered Formally Inspected in their entirety.

It is recommended that once the trees have been cleared that they are Formally Inspected again.

Tree Tags:

Trees that require works will be tagged if this is required to identify the tree on the ground.

This means the tree will have two numbers – the 'T' number that identifies the tree on the Tree Survey Plan (this number is chronological and starts at 1 and finishes with the last tree surveyed).

The Tag Number may be any number but is there to identify the tree on the ground. This enables two trees next to each, and close together on the plan, to be positively identified by the arborist so that the correct works are carried out on the right tree.

Definition of Terms

Tree / Group No.	Identification reference T= individual tree, G= groups of trees – this is the number shown on the Tree Survey Plans	
Tag Number	Number stamped on tag that is nailed to tree to identify it, enabling certainty when carrying out recommended works by cross referencing with T number on plan (tag number is not necessarily the same as the T number and usually found at approximately 2 metres above ground level on the north side of the stem)	
Species	Botanical and common name	
Height	Estimated height of tree in metres	
DBH	Estimated stem diameter taken at 1.5 metres above ground level in centimetres	
Crown Spread	Estimated crown spread averaged over the four cardinal points in metres	
Bat Potential	An assessment identifying Potential Bat Features (PRF's) following BS8596 (2015): Surveying for Bats in Trees and Woodland – Guide. Trees are rated as Negligible / Low / Medium / High / Confirmed	
Vitality	An assessment of the tree's dynamic characteristics:	
	High	Normal or higher growth for the species in its environment
	Moderate	Below normal growth for the species in its environment
	Low	Sparse / weak growth for the species in its environment
	Moribund	Approaching death – very minor live growth but clearly declining – practically dead
Age Class	Dead	A dead tree, no live growth
	Young	A small tree recently planted or establishing naturally self-sown, in the very early stages of growth
	Semi mature	An established tree in the first third of life span for its species with significant growth potential
	Early mature	In the second third of life span with some growth potential, but less vigorous
	Mature	Tree that has reached its optimum crown size and growth potential for its species, last third of life span
Physiological Condition	Ancient / veteran	Ancient trees are those which have reached a great age in comparison with others of the same species. A veteran tree can be any age, but it is a tree which shows ancient characteristics
	Good	Full healthy crown density, normal extension growth, foliage colour and size normal, limited deadwood, functioning well and able to adapt to well to its environment
	Fair	Showing minor signs of decline, slow extension growth, possibly yellowing leaves, numerous deadwood present
Structural Condition	Poor	Poor crown density for its age and species, small developed leaves, limited extension growth, generally functioning poorly, in decline, major deadwood present
	Good	No adverse risk of failure, minor defects, with little overall significance
	Fair	Defects present that may require work mitigate risk of failure
Deadwood	Poor	Major structural defects, unlikely to return to good structural condition following remedial works, may have significant decay, cavities, cracks etc
	Minor	Diameter up to 50mm
	Major	Diameter > 50mm
Target	People or property at risk from the tree	
Priority	Timescale in which recommended work should be carried out – urgency depending on estimated timescale of failure / level of risk of failure / risk of harm / risk of damage: Immediate / within 7 days / within 1 month / within 3 months / within 6 months / within 1 year / within 2 years	

Qualifications

Ade Clarke, a qualified arboriculturist with extensive experience spanning thirty years working with trees. Areas of expertise include tree risk, detailed tree assessment and ancient tree management.

An experienced tree surveyor managing tree risk at various levels - from surveying to advising on policy and procedures for whole tree populations.

Over the several years, Ade has specialised in the very detailed analysis of tree condition and structural integrity with the use of tomography, aerial tomography, and stability assessments, often enabling the retention of the most valuable trees in high target areas that otherwise may be removed or have inappropriate tree surgery carried out due to the perceived risk.

Involved with ancient trees since 1992, Ade has experience of every aspect of ancient tree management, including the management of individual ancient trees in relation to risk, to strategic management of the most important ancient tree populations.

Ade Clarke is a Chartered Forester, a Registered Consultant and Professional Member with the Institute of Chartered Foresters, and a Professional Member of the Arboricultural Association.



Ade Clarke MICFor. MArborA





Excellence in Arboriculture



info@tracyclarke.co.uk



www.tracyclarke.co.uk



01371 811831

